

# UBC/UBF

## TANK WASHING

### SINGLE-AXIS ROTARY WASHERS

#### UBC

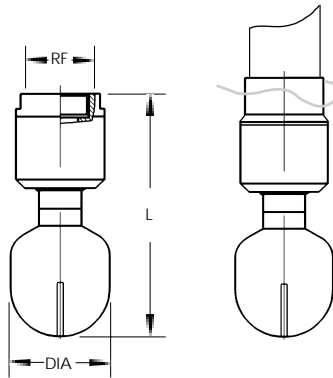

**UBC** type rotary tank washer nozzles contain slotted, flat-shaped spray orifices positioned such that the jets provide the reaction forces to produce the rotary motion. This simple yet robust design, utilizing two ball bearing assemblies, makes it possible to operate the nozzle in any orientation, giving an efficient 360° of coverage.

The largest UBC nozzle can accommodate tanks up to 15 feet in diameter for deep washing and 20 feet for rinsing. All of the other nozzles listed in the table have a washing range of 10 feet and a rinsing range of 14 feet.

The body, bearings and races are all fabricated from 316 stainless steel. The UBC series is supplied either with a standard threaded female pipe connection or, for applications where frequent cleaning is required, a slip-on fitting with a safety locking pin. To order the slip-on fitting add the letter 'C' to the nozzle code shown in the table.

Nozzle code	RF	Flow rates (gpm) at various pressures (psi)				Angle AA	Max. Throw MT	Weight W	Dimensions	
		30	45	75	105				L	DIA
UBC 2899 B3x	1/2"	19	24	31	43	360	80"	0.66	4 1/2"	1 3/4"
UBC 2900 B3x	3/4"	19	24	31	43	360	80"	0.66	4 1/2"	1 3/4"
UBC 3120 B3x	1"	26	32	41	48	360	80"	1.3	4 1/2"	1 3/4"
UBC 3300 B3x	1 1/4"	65	79	103	121	360	80"	1.5	5"	2 3/8"

Connection: Female thread  
Slip-on fitting (add 'C' to nozzle code)

Materials: All 316 stainless steel

#### UBF

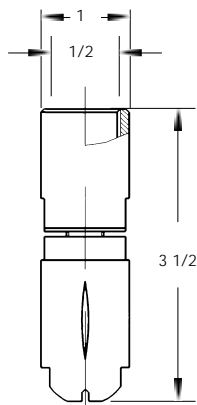

**UBF** type rotary tank washer nozzles contain all the features of the UBC series, but are designed to operate in smaller size tanks that contain relatively limited size openings such as found in pressurized soft-drink containers and beer kegs.

The spray coverage from type UBF nozzles is 270°. The body, bearings and races are all fabricated from 316 stainless steel.

Connection: Female thread

Materials: All 316 stainless steel

Nozzle code	Flow rates (gpm) at various pressures (psi)					Angle AA	Max. Throw MT	Weight W
	15	45	75	150	180			
UBF 2270 B3	4	7	10	14	15	270	60"	0.5
UBF 2380 B3	6	10	13	18	20	270	60"	0.5